

reflecta gmbh  
Junghansring 60  
72108 Rottenburg  
Germany

mail@reflecta.de  
www.reflecta.de

## INSTALLATION MANUAL

### For 5° Pitching Angle Mounting

### Hanging the TV onto the Wall Plate

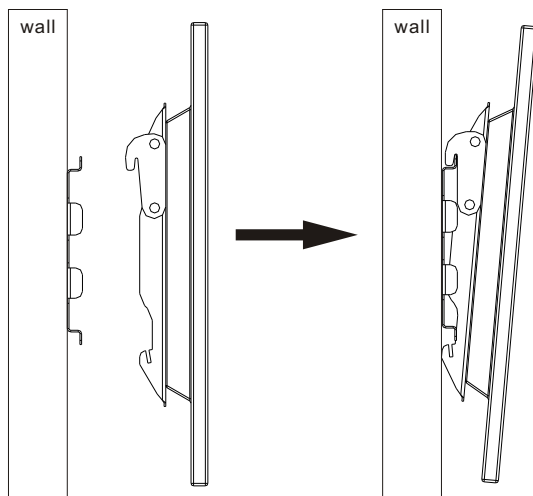
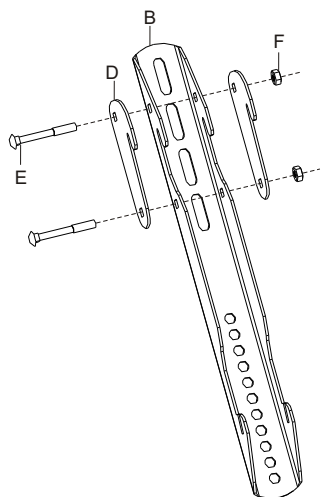

Attach the tilt options to the TV rails using supplied screws and lock nuts.  
**Important:** Make sure the TV is safely secured before releasing.

### 4. Locking the TV Rails

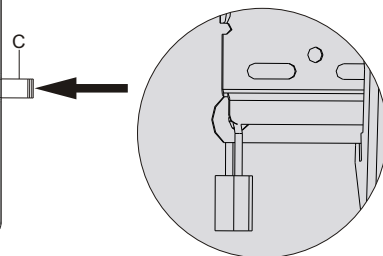
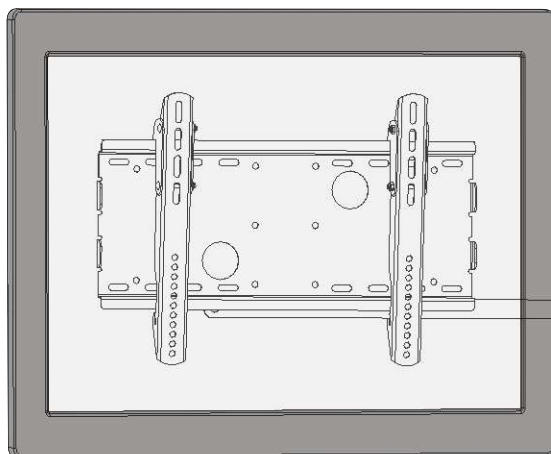

Insert the safety bar to secure the rails.

Use the padlock to prevent TV from being stolen.  
(The padlock is not included)

### Maintenance

- Check that the bracket is secure and safe to use at regular intervals(at least every three months).
- Please contact your distributor if you have any questions.

## Fixed Wall Mount

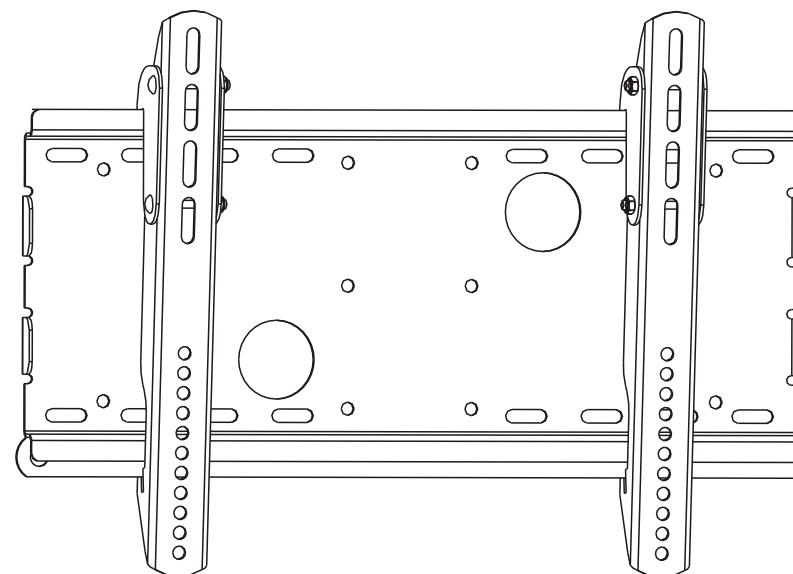

**CAUTION:** DO NOT EXCEED RATED LISTED WEIGHT CAPACITY. SERIOUS INJURY OR PROPERTY DAMAGE MAY OCCUR!

23081

23086



100x100/200x100  
200x200/300x300  
400x200



ISSUED: APR. 2013

**NOTE:** Read the entire instruction manual before you start installation and assembly.

## WARNING

- Do not begin the installation until you have read and understood all the instructions and warnings contained in this installation sheet. If you have any questions regarding any of the instructions or warnings, please contact your local distributor.
- This mounting bracket was designed to be installed and utilised **ONLY** as specified in this manual. Improper installation of this product may cause damage or serious injury.
- This product should only be installed by someone with good mechanical ability who has basic building experience and fully understands this manual.
- Make sure that the supporting surface will safely support the combined weight of the equipment and all attached hardware and components.
- If mounting to wood wall studs, make sure that mounting screws are anchored into the center of the studs. The use of a stud finder is highly recommended.
- Always use an assistant or mechanical lifting equipment to safely lift and position the equipment.
- Tighten screws firmly, but do not over tighten. Over tightening can cause damage to the items, This greatly reduces their holding power.
- This product is intended for indoor use only. Using this product outdoors could lead to product failure and personal injury.

## Component Checklist

**IMPORTANT:** Ensure that you have received all parts according to the component checklist prior to installation. If any parts are missing or faulty, contact the distributor for a replacement.

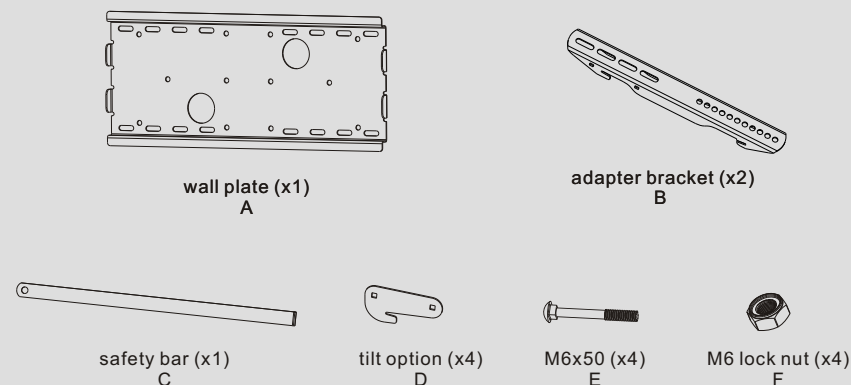

### Package M

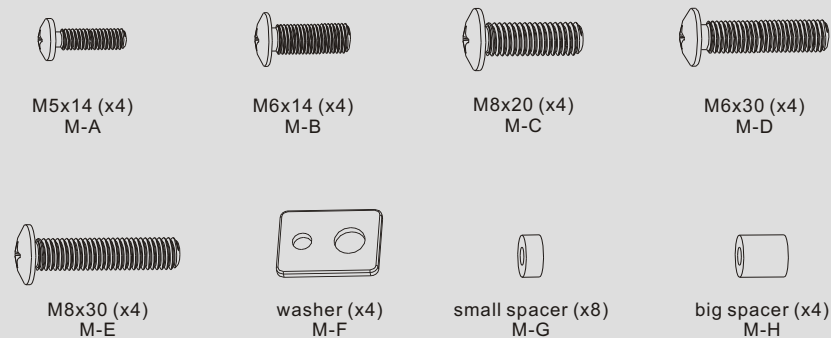

### Package W

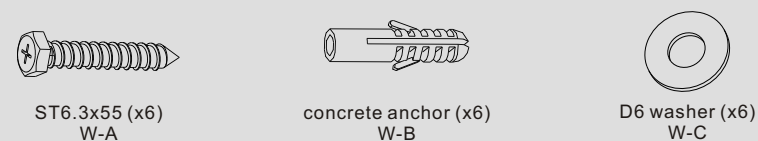

## 1a. For Wood Stud Wall Mounting

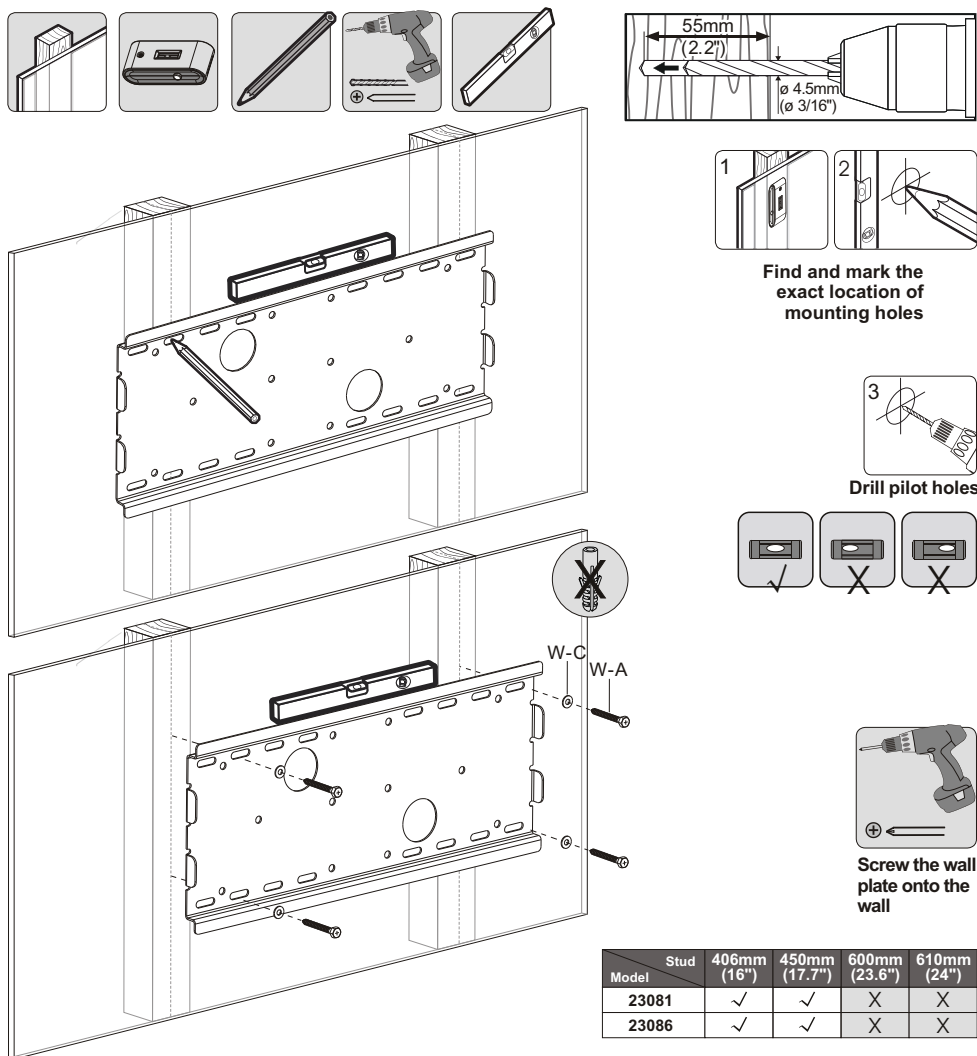

### ! WARNING

- Make sure that mounting screws are anchored into the center of the studs. The use of a stud finder is highly recommended.
- Installers are responsible to provide hardware for other types of mounting situations.
- Installers must verify that the supporting surface will safely support the combined weight of the equipment and all attached hardware and components.

## 1b. For Solid Brick and Concrete Mounting

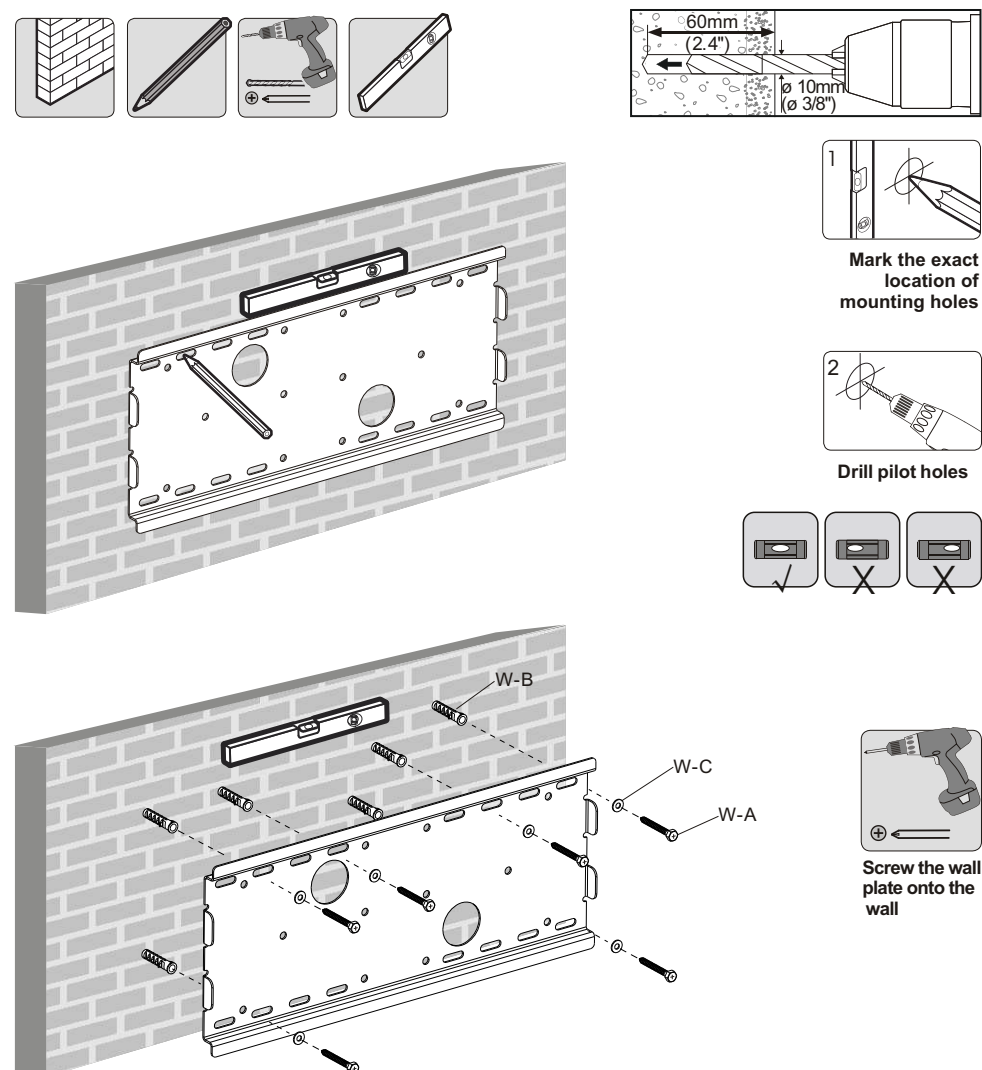

### ! WARNING

Installers must verify that the supporting surface will safely support the combined weight of the equipment and all attached hardware and components.

## 2. Installing the Adapter Brackets

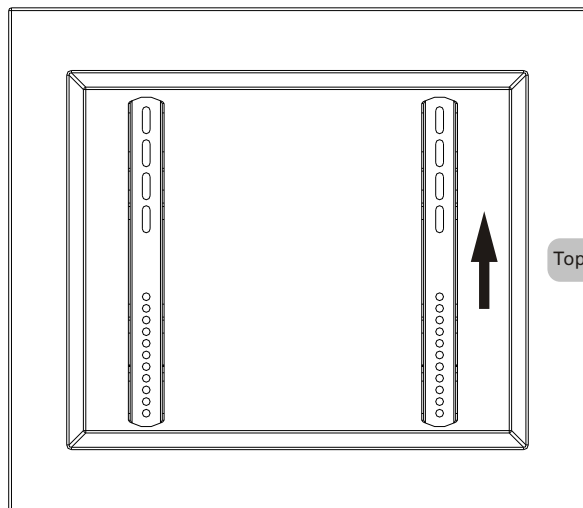

Top of the TV

### 2-1 For Flat Back Screens

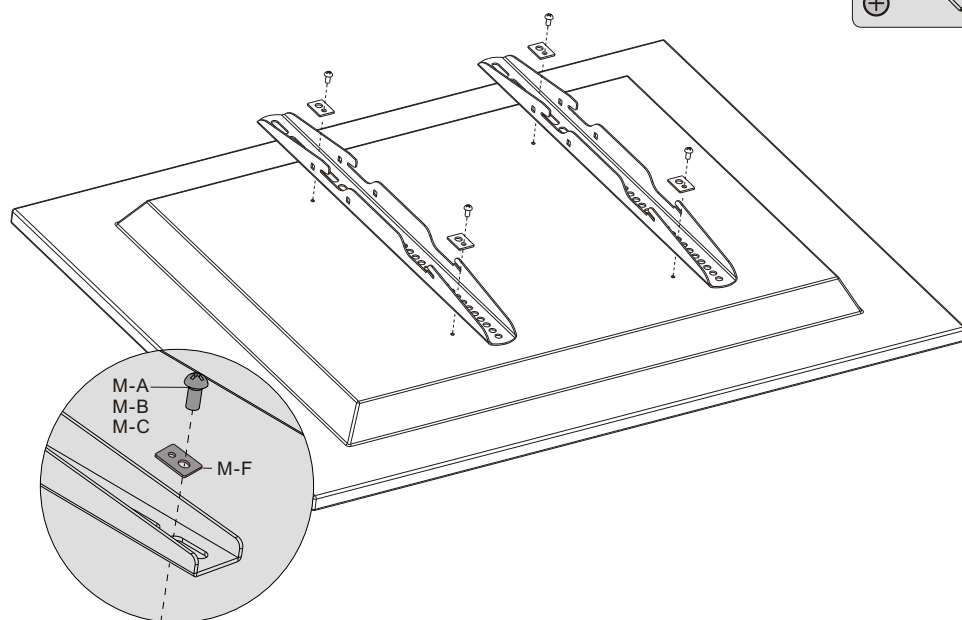

### 2-2 For Recessed Back Screens or to Access A/V Inputs

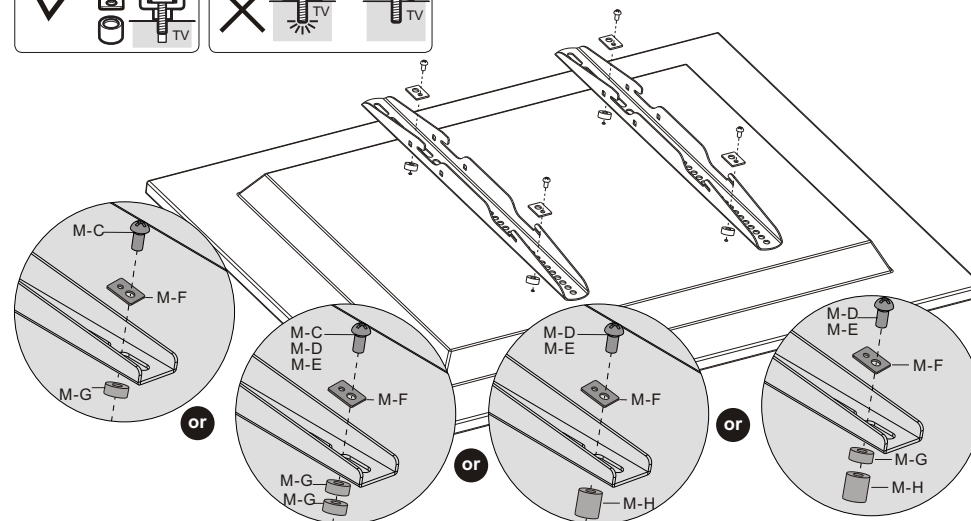
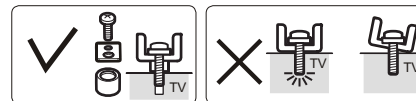

**Note:** Choose the appropriate screws, washers and spacers (if necessary) according to the type of screen.

- Position the adapter brackets as close as possible to the center of the TV.
- Screw the adapter brackets onto the TV.

**⚠ Tighten all screws but do not over tighten.**

## 3. Hanging the TV onto the Wall Plate

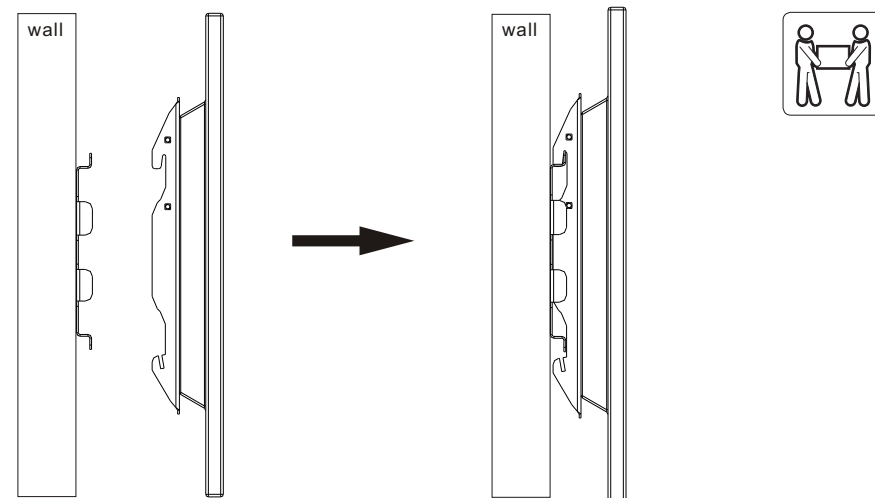

Lift your TV and hook the top hooks over the top of wall plate rail.